

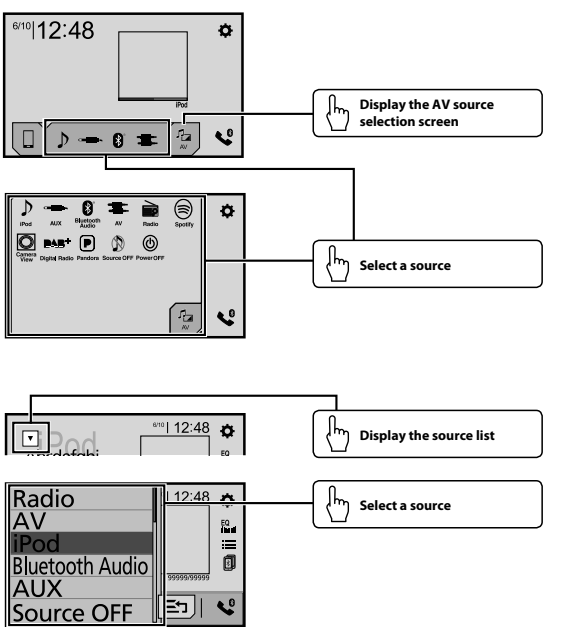



### Selecting the source



### Setting the clock

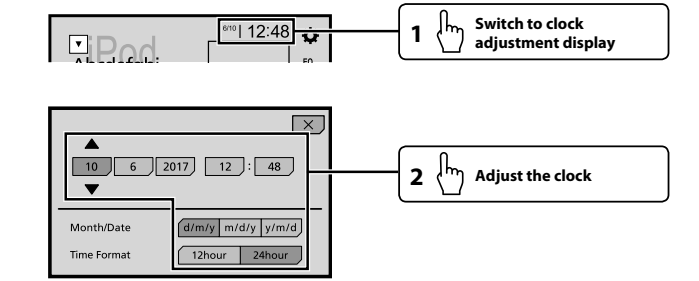

### Tuner operation

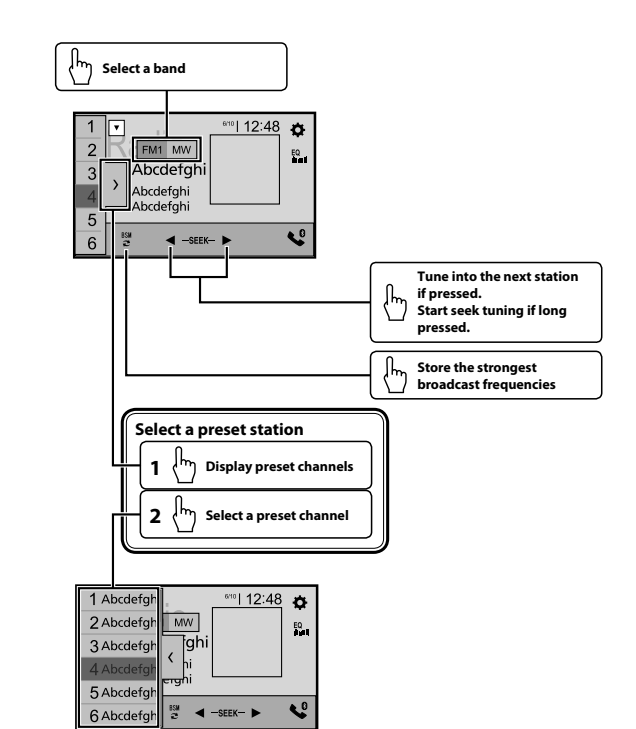

### Moving images operation

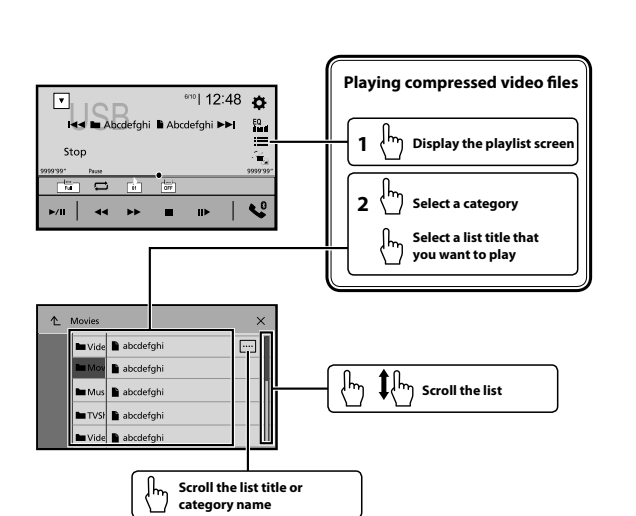

### Audio operation

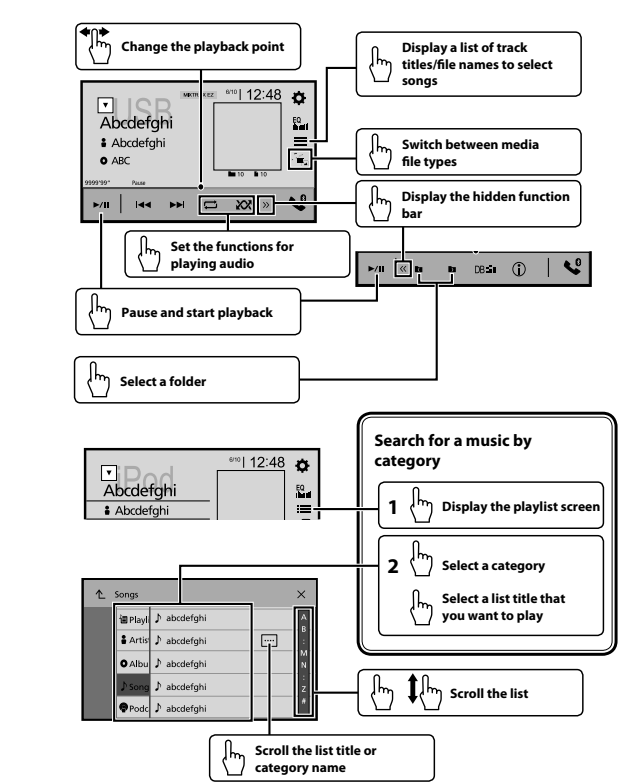

### Bluetooth telephone operation

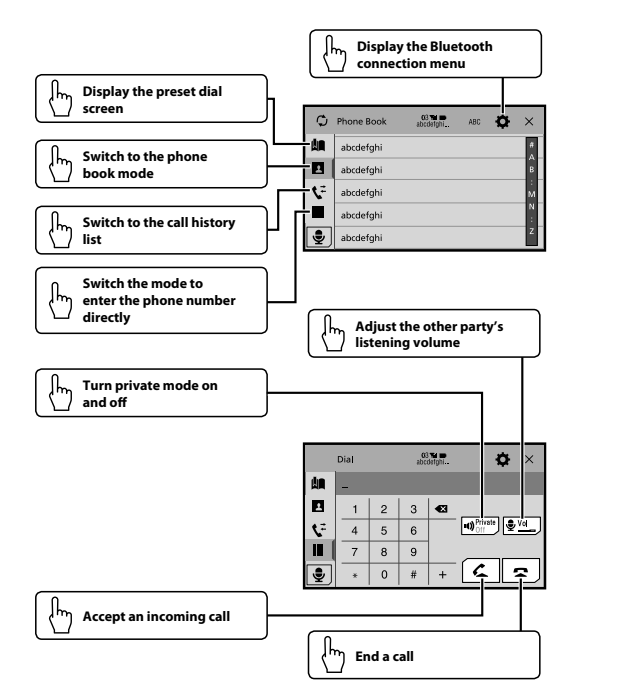

### What's What

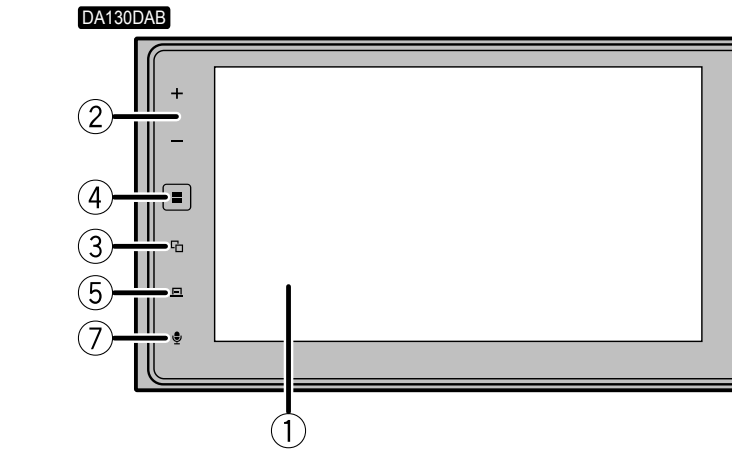
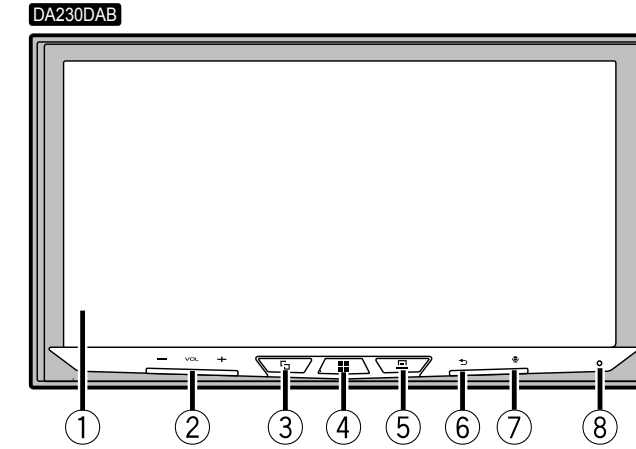

- 1 LCD screen
- 2 VOL (+/-) button
- 3 button  
To switch between the Application screen and the AV operation screen.  
For SPH-DA230DAB, press and hold to switch to the camera view mode, and for SPH-DA130DAB, press and hold to turn off the display.
- 4 button  
To display the top menu screen.  
Press and hold to power off.
- 5 button  
To display the menu bar.  
Press and hold to mute or unmute.
- 6 button  
To display the top menu screen or back to previous screen.  
Press and hold to turn off the display.
- 7 button  
To activate the voice recognition mode such as Siri when iPhone is connected to the unit via Bluetooth or USB.
- 8 RESET button

## Sélection de la source

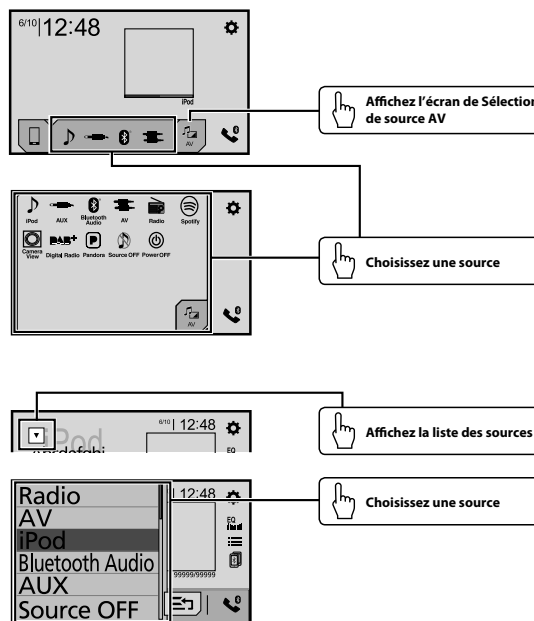

## Réglage de l'horloge

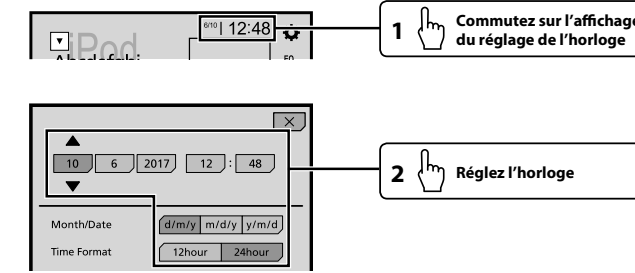

## Utilisation du tuner

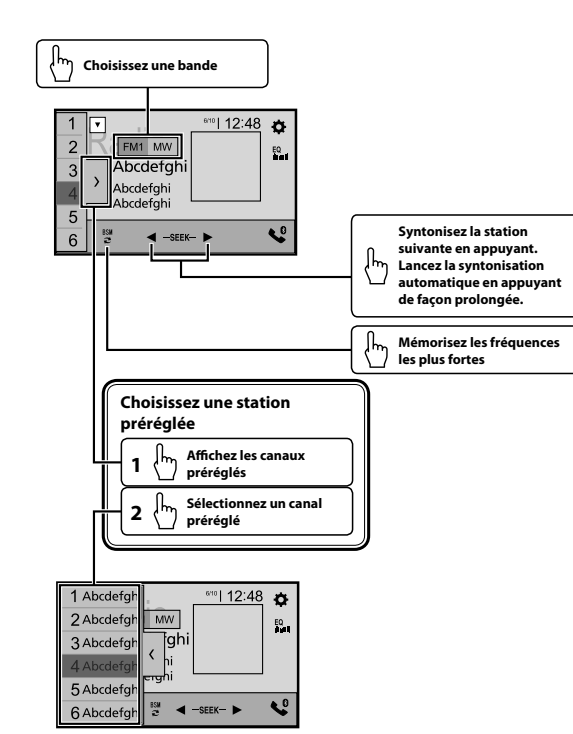

## Exploitation des images animées

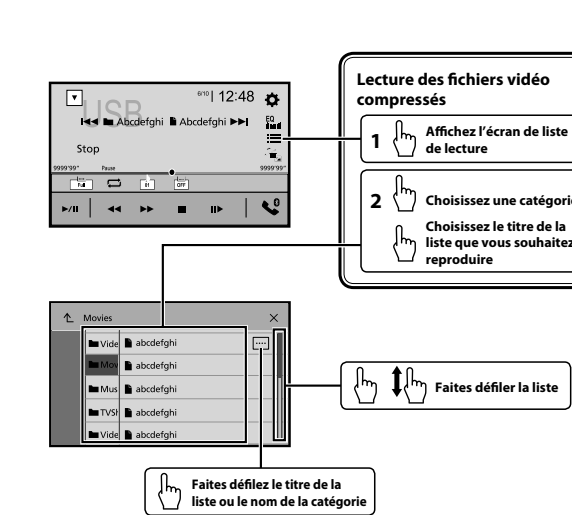

## Opérations audio

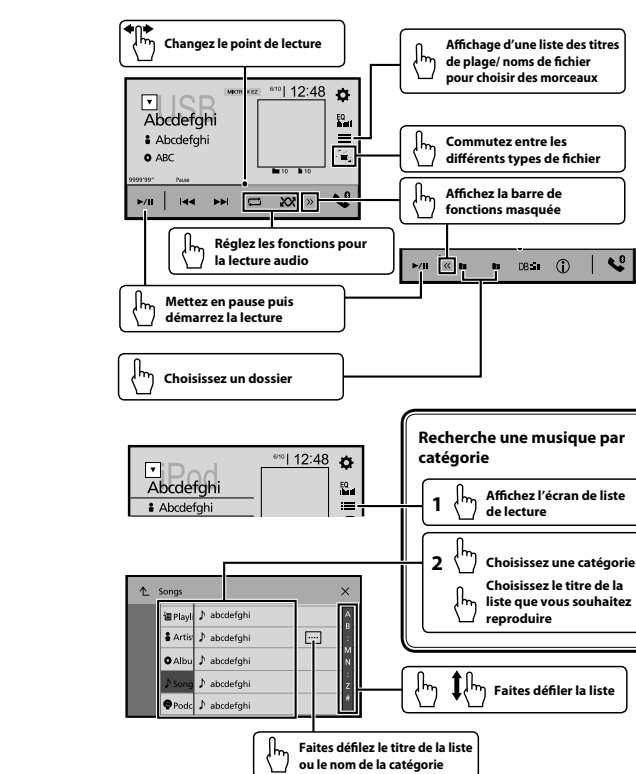

## Utilisation d'un téléphone Bluetooth

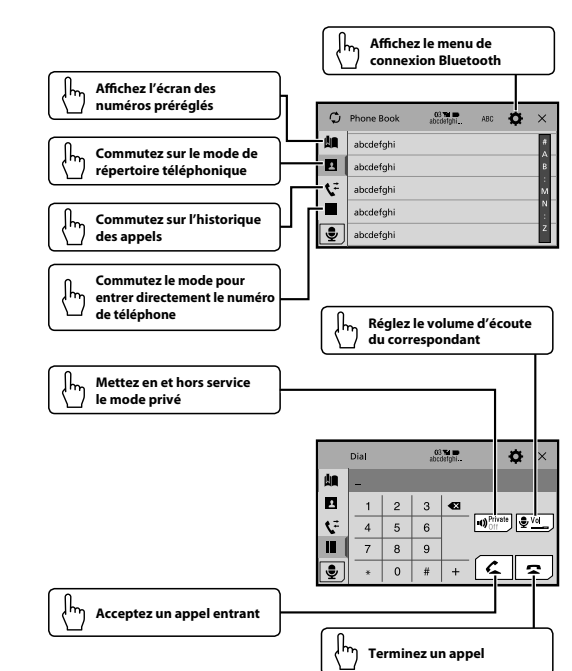

## Description de l'appareil

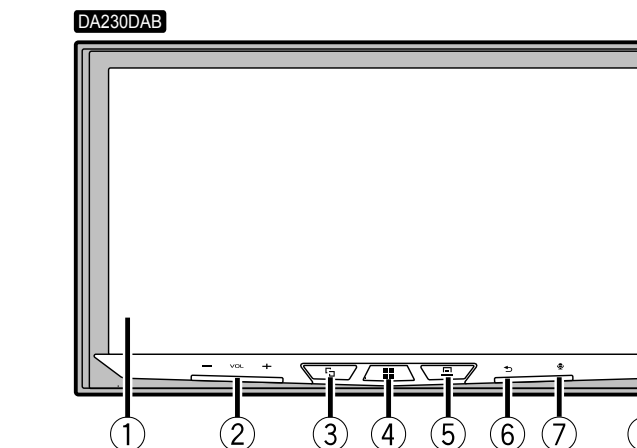

- 1 Écran LCD
- 2 Bouton **VOL** (+/-)
- 3 Bouton
- 4 Bouton
- 5 Bouton
- 6 Bouton
- 7 Bouton
- 8 Bouton RESET

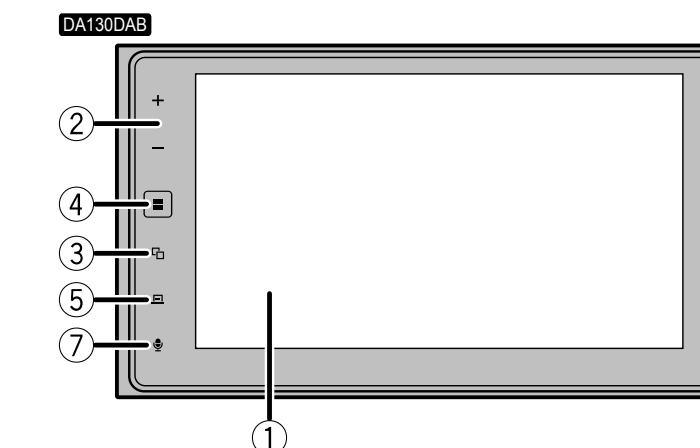

- 1 Écran LCD
- 2 Bouton **VOL** (+/-)
- 3 Bouton
- 4 Bouton
- 5 Bouton
- 6 Bouton
- 7 Bouton

Pour passer de l'écran de l'application à l'écran d'opération AV.  
 Pour SPH-DA230DAB, maintenez la touche enfoncée pour basculer en mode Visualisation des caméras, et pour SPH-DA130DA, maintenez le doigt sur la touche pour désactiver l'affichage.

4 Bouton Pour afficher le menu principal.  
 Maintenez la touche enfoncée pour mettre l'appareil hors tension.

5 Bouton Pour afficher la barre de menu.  
 Maintenez la touche enfoncée pour activer ou désactiver.

6 Bouton Pour afficher le menu principal ou revenir à l'écran précédent.  
 Maintenez la touche enfoncée pour désactiver l'affichage.

Lorsque l'affichage est désactivé, touchez l'écran pour revenir à l'écran initial.

7 Bouton Pour activer le mode de reconnaissance vocale tel que Siri lorsque l'iPhone est connecté à l'appareil en Bluetooth ou via l'USB.

: Toccare : Toccare e trascinare

### Selezione della sorgente

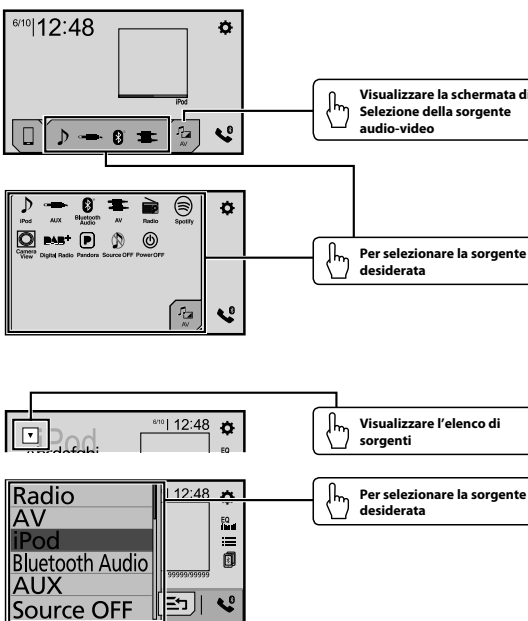

### Impostazione dell'orologio

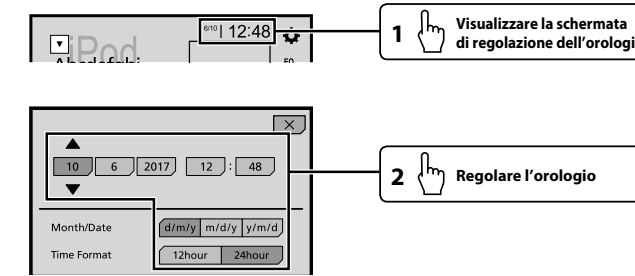

### Uso del sintonizzatore

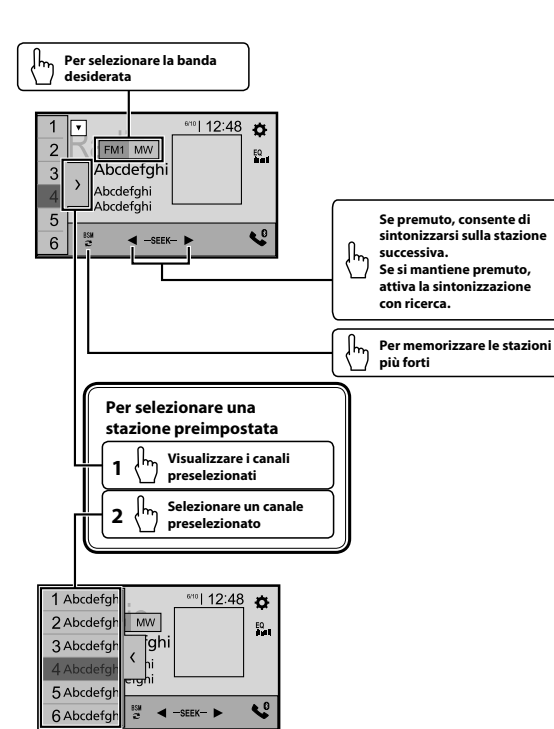

### Uso delle immagini video

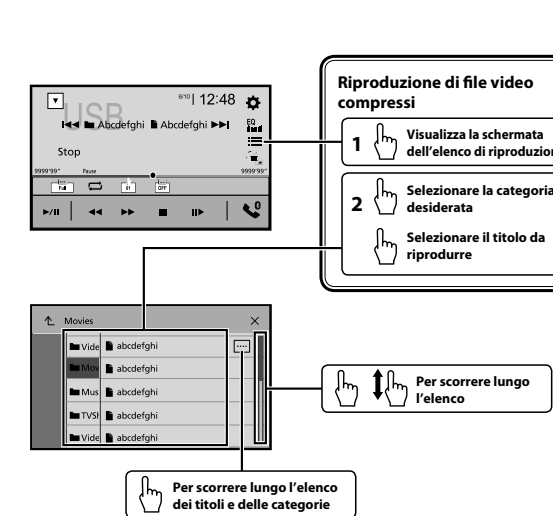

### Uso delle funzioni audio

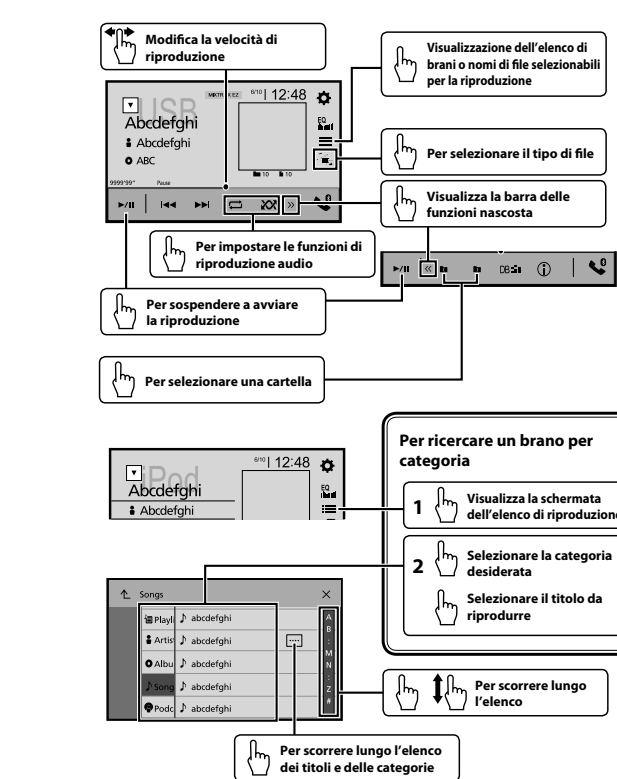

### Uso del telefono Bluetooth

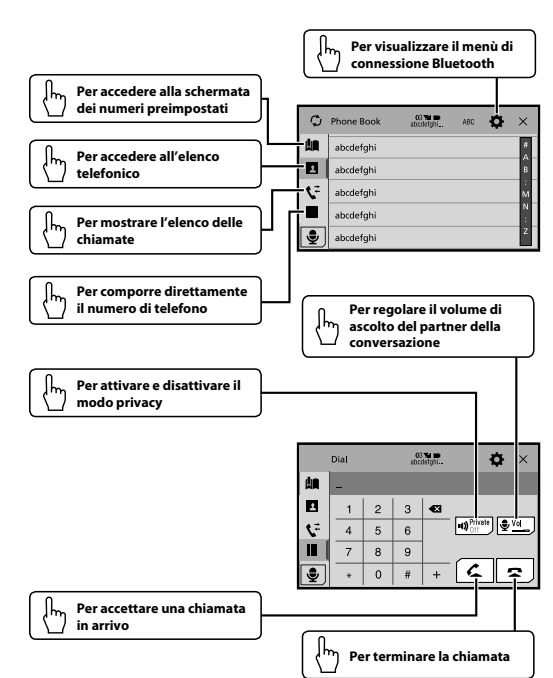

### Nomenclatura

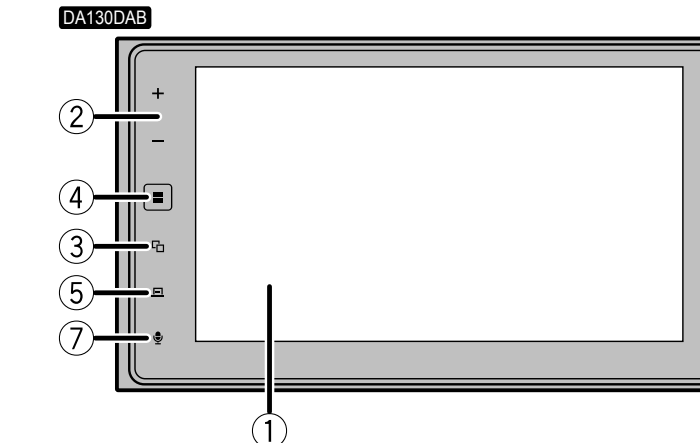
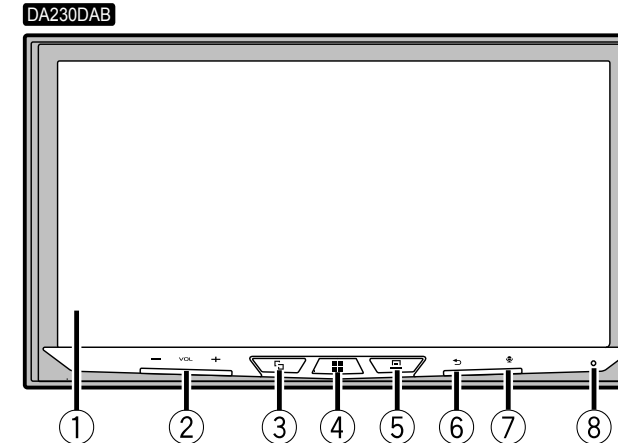

- 1 Schermo LCD
  - 2 Pulsante VOL (+/-)
  - 3 Pulsante
  - 4 Pulsante
  - 5 Pulsante
  - 6 Pulsante
  - 7 Pulsante
  - 8 Pulsante RESET
- Per passare dalla schermata dell'applicazione alla schermata operativa AV. Per SPH-DA230DAB, tenere premuto per passare alla modalità di visualizzazione fotocamera, mentre per SPH-DA130DAB, tenere premuto per spegnere il display.
- Per visualizzare la schermata del menu principale. Tenere premuto per spegnere.
- Per visualizzare la barra del menu. Tenere premuto per disattivare o attivare l'audio.
- Per visualizzare la schermata del menu principale o tornare alla schermata precedente. Tenere premuto per spegnere il display.
- Quando il display è spento, toccare lo schermo per tornare alla schermata originale.
- Per attivare la modalità di riconoscimento vocale, come ad esempio Siri quando un iPhone è collegato all'unità mediante Bluetooth o USB.



## Seleccionar la fuente

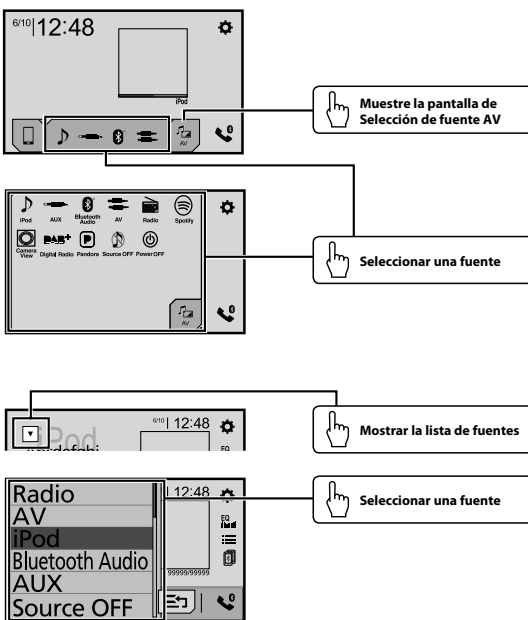

## Ajuste del reloj

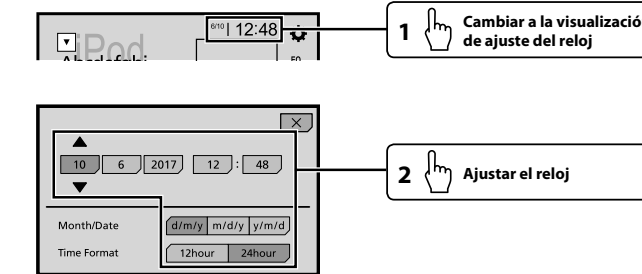

## Operación del sintonizador

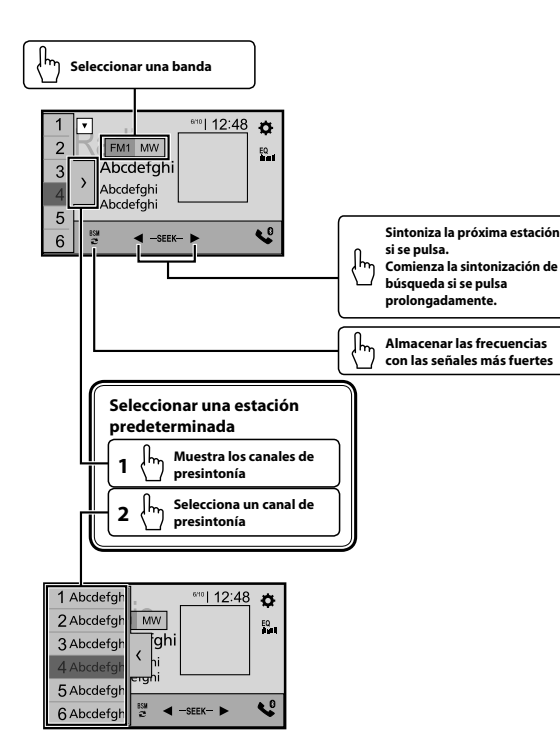

## Operación de imágenes en movimiento

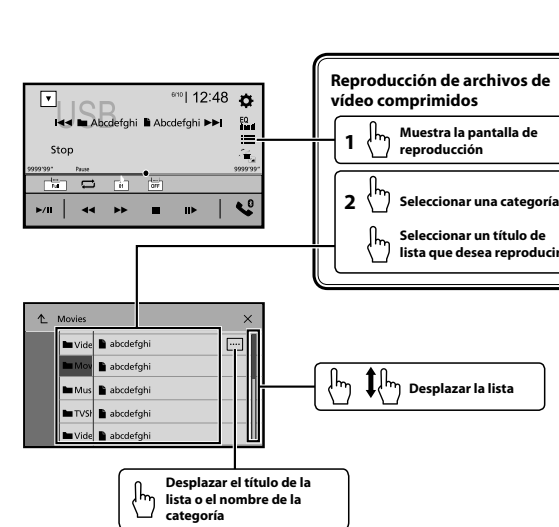

## Operación de audio

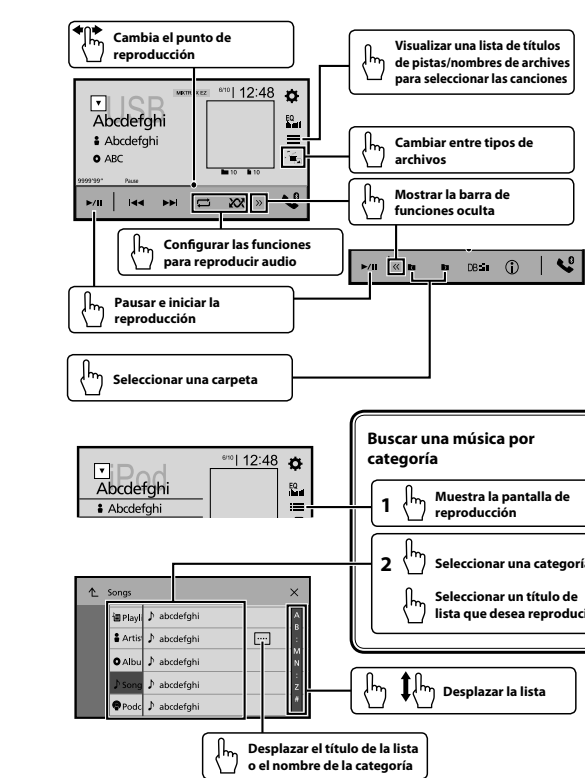

## Operación con teléfono Bluetooth

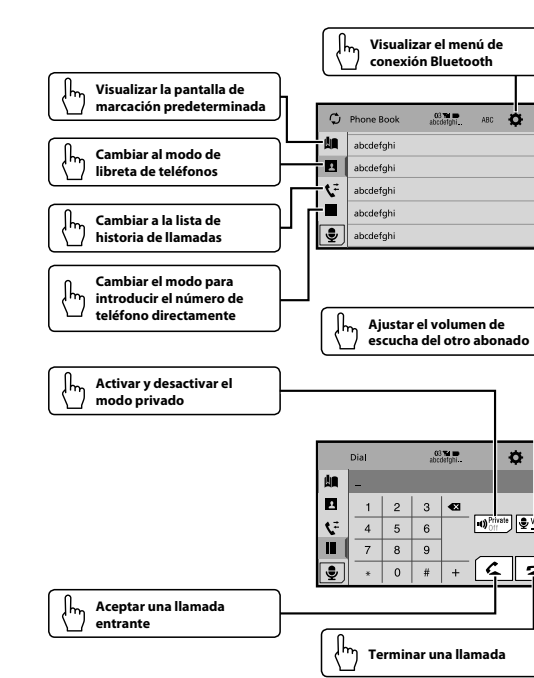

## Qué es cada cosa

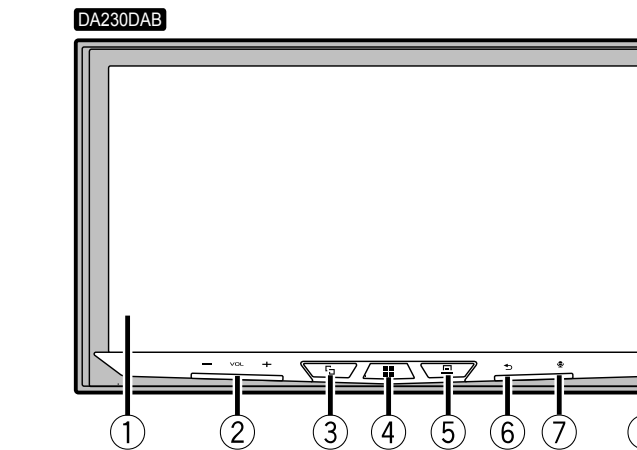

- 1 Pantalla LCD
  - 2 Botón **VOL** (+/-)
  - 3 Botón
  - 4 Botón
  - 5 Botón
  - 6 Botón
  - 7 Botón
  - 8 Botón **RESET**
- Para alternar entre la pantalla de aplicaciones y la pantalla de operaciones AV. En el caso de SPH-DA230DAB, mantenga pulsado para cambiar al modo de visualización de cámara y, en el caso de SPH-DA130DAB, toque y mantenga presionado para desactivar la visualización.
- Manténgalo pulsado para apagar.
- Manténgalo pulsado para silenciar o activar el sonido.
- Manténgalo pulsado para apagar la pantalla.
- Con la pantalla apagada, toque el panel para volver a la pantalla original.
- Para activar el modo de reconocimiento de voz, como Siri cuando el iPhone está conectado a la unidad a través de Bluetooth o USB.

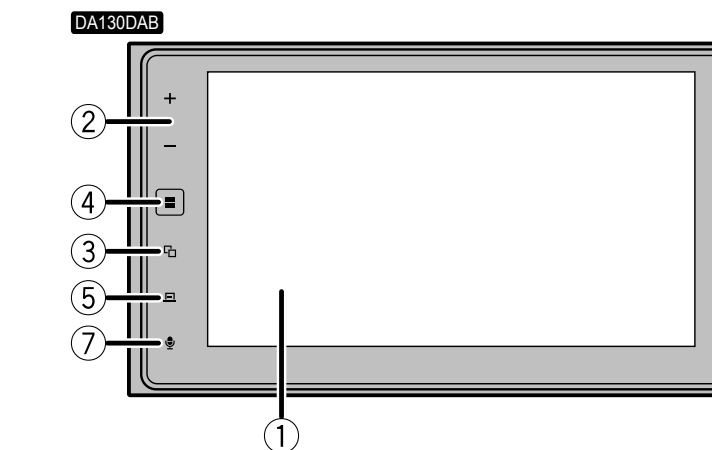

### Wahl der Signalquelle

: Antippen : Antippen und schieben

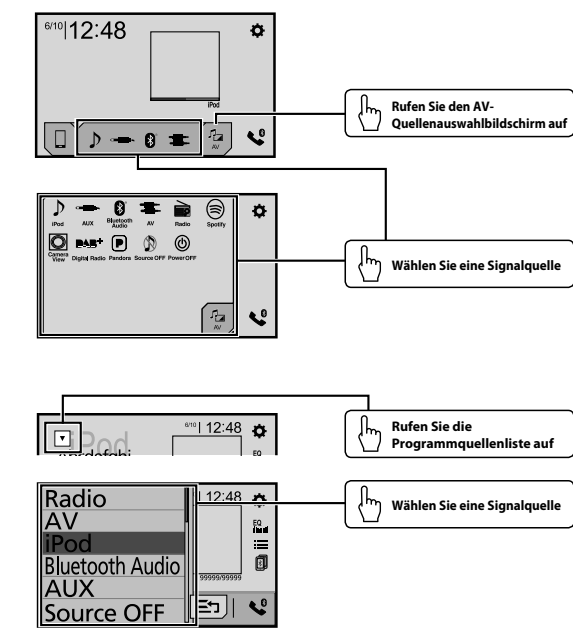

### Einstellen der Uhrzeit

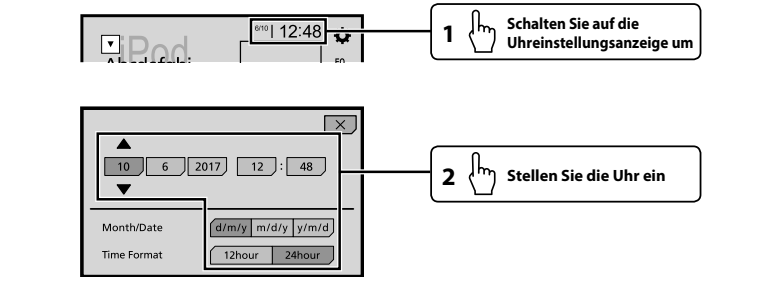

### Tuner-Betrieb

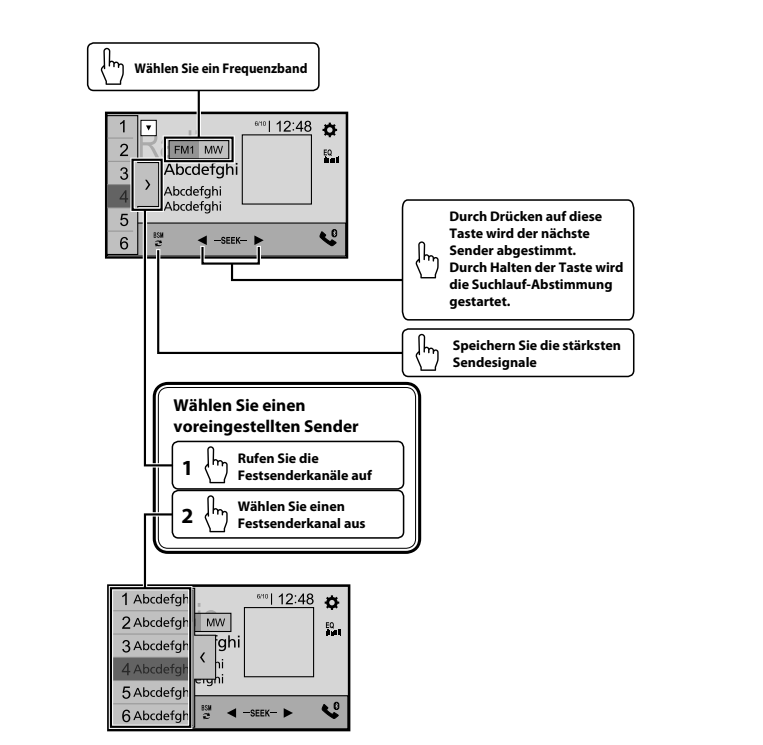

### Bewegbild-Betrieb

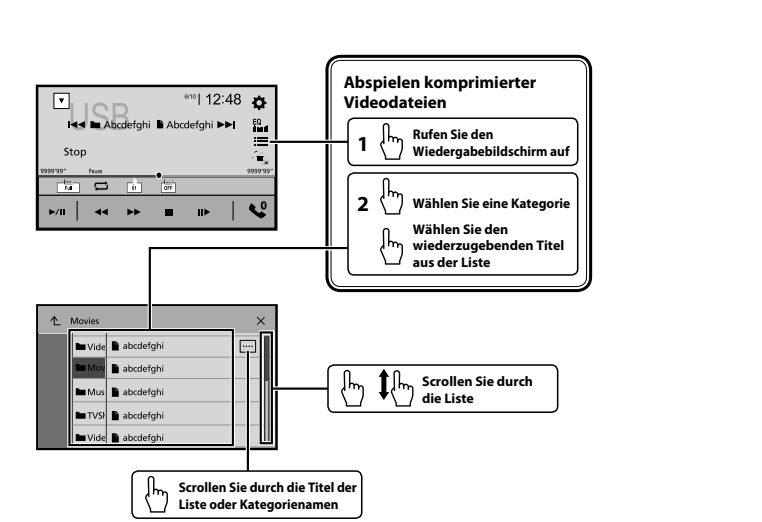

### Audio-Betrieb

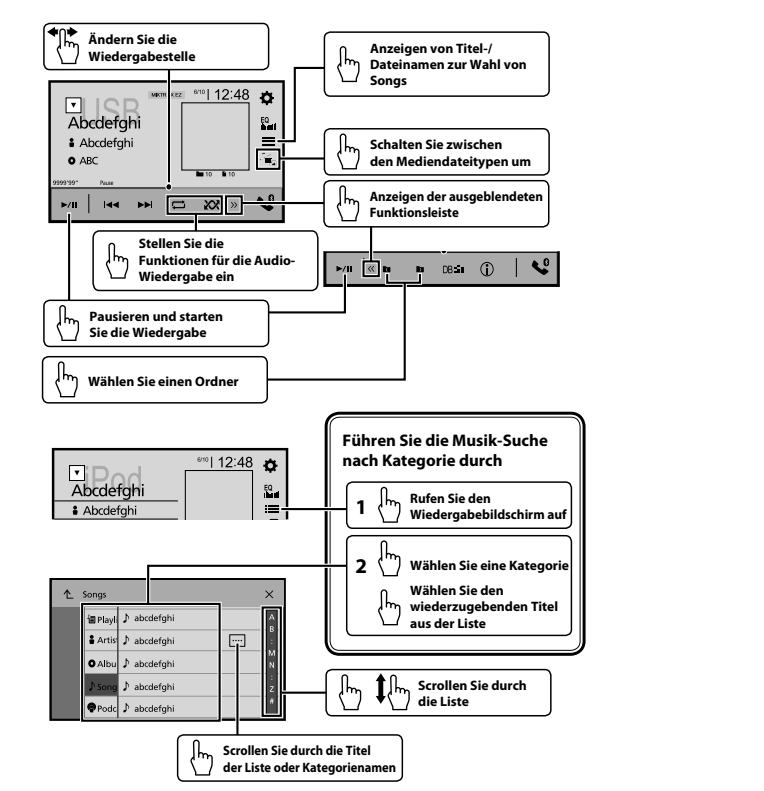

### Bluetooth-Telefonbetrieb

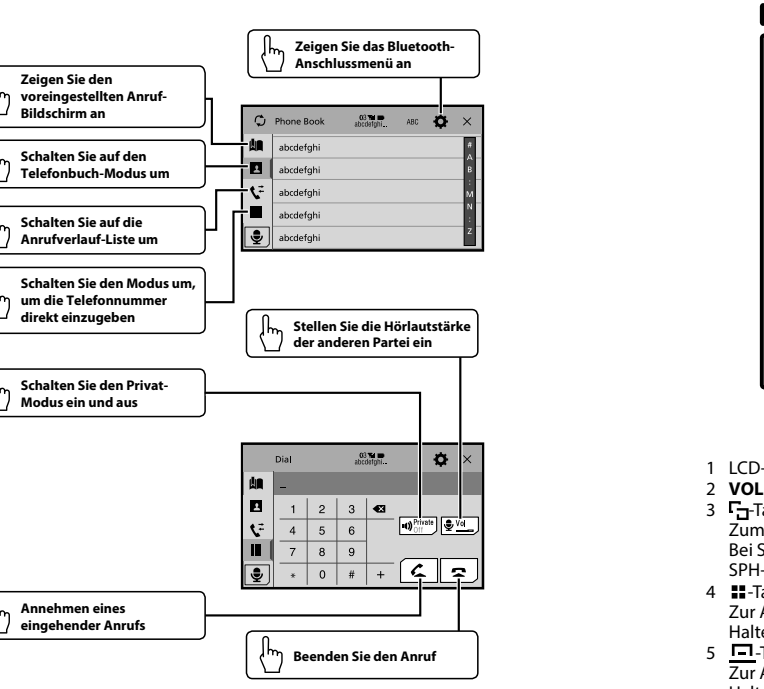

### Die einzelnen Teile

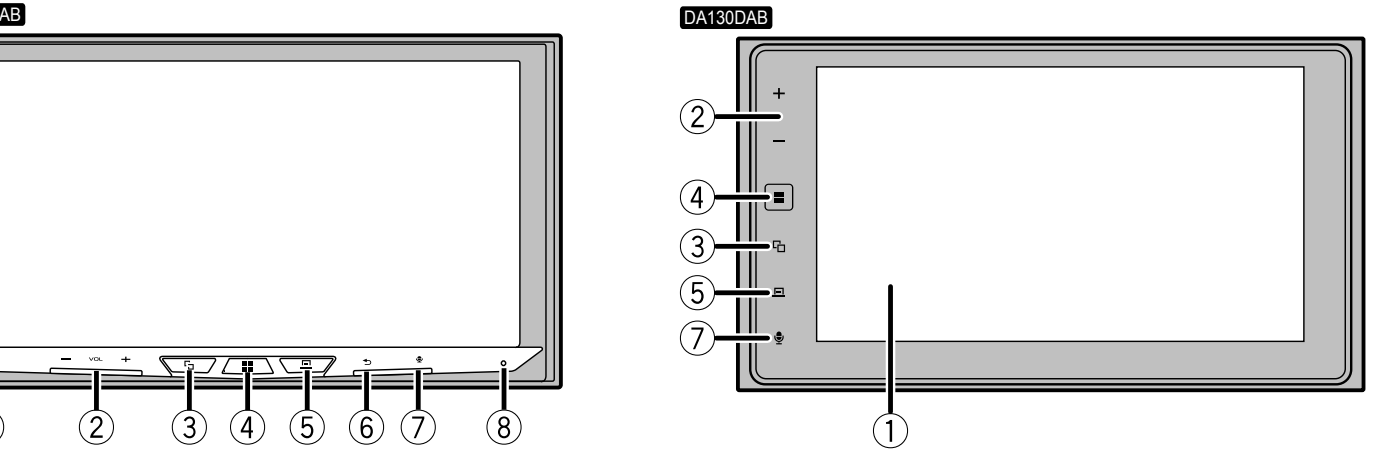

- LCD-Bildschirm
- VOL (+/-)-Taste
- ☐-Taste  
Zum Umschalten zwischen dem Anwendungsbildschirm und dem AV-Funktionsbildschirm. Bei SPH-DA230DAB drücken und halten, um zum Kameraansichtsmodus umzuschalten, bei SPH-DA130DAB drücken und halten, um das Display auszuschalten.
- ☐-Taste  
Zur Anzeige des Hauptmenübildschirms. Halten Sie die Taste zum Ausschalten gedrückt.
- ☐-Taste  
Zur Anzeige der Menüleiste. Halten Sie die Taste gedrückt, um die Stummschaltung zu aktivieren oder zu deaktivieren.
- ☐-Taste  
Zur Anzeige des Hauptmenübildschirms oder zur Rückkehr zum vorherigen Bildschirm. Halten Sie die Taste zum Ausschalten des Displays gedrückt.  
☐ Wenn das Display ausgeschaltet ist, berühren Sie den Bildschirm, um wieder den ursprünglichen Bildschirm anzuzeigen.
- ☐-Taste  
Zur Aktivierung des Spracherkennungsmodus, wie zum Beispiel Siri, wenn ein iPhone über Bluetooth oder USB mit dem Gerät verbunden ist.
- RESET-Taste

### Selecteren van de signaalbron

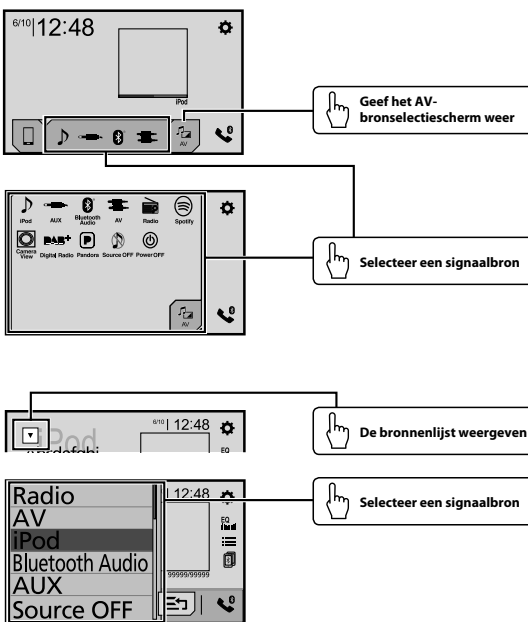

### De klok instellen

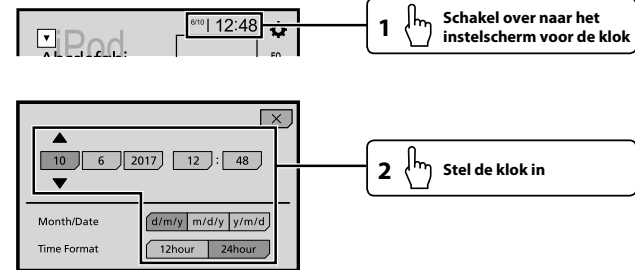

### Bediening van de tuner (radio)

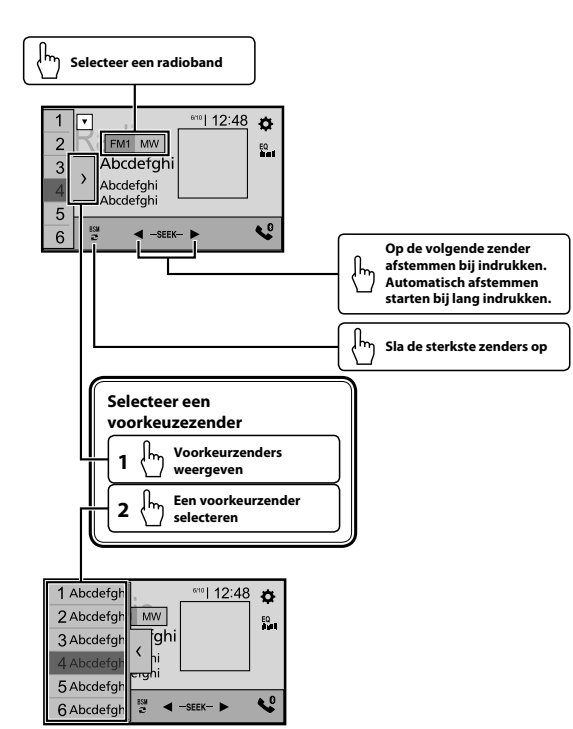

### Bediening bewegende beelden

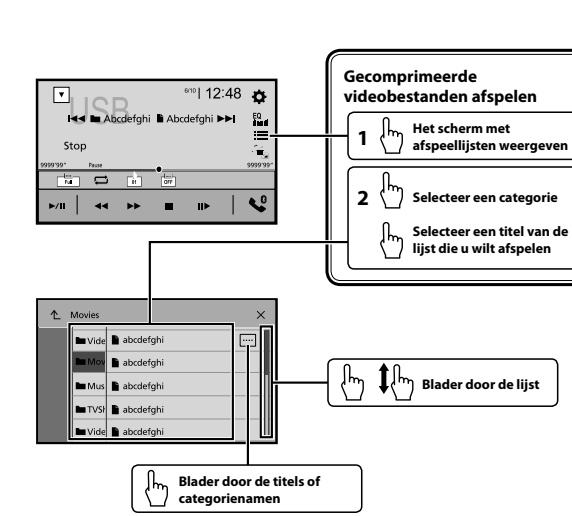

### Bediening audiofuncties

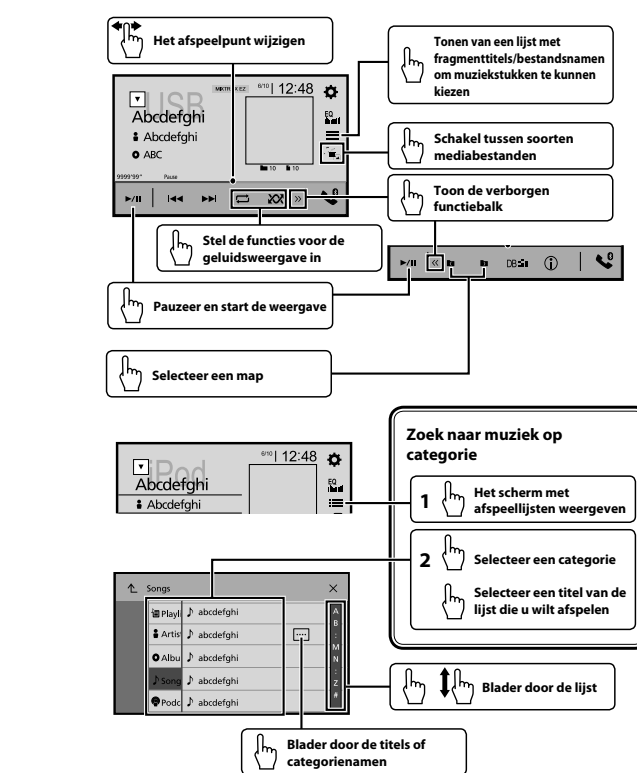

### Bediening Bluetooth telefoon

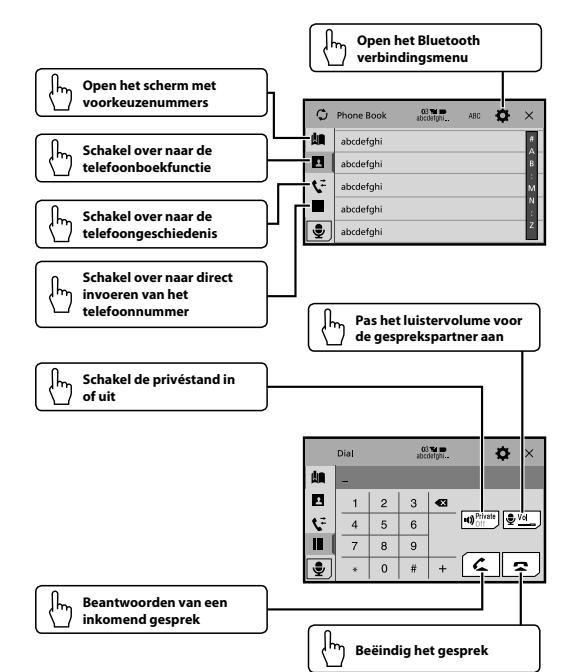

### Wat is wat

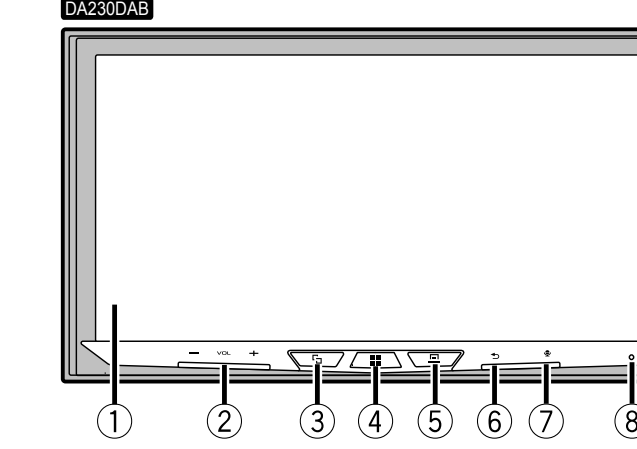

- 1 LCD-scherm
- 2 VOL (+/-)-toets
- 3 -toets
- Om te schakelen tussen het applicatiescherm en het AV-bedieningsscherm. Houd voor SPH-DA230DAB ingedrukt om naar de stand voor cameraweergave te gaan, terwijl u voor SPH-DA130DAB ingedrukt houdt om het display uit te schakelen.
- 4 -toets
- Om het beginmenu weer te geven. Houd ingedrukt om het apparaat uit te schakelen.
- 5 -toets
- Om de menubalk weer te geven. Houd ingedrukt om het geluid te dempen of weer te geven.
- 6 -toets
- Om het hoofdmenu weer te geven of om naar het vorige scherm terug te keren. Houd ingedrukt om het display uit te schakelen.
- Wanneer het display is uitgeschakeld, tikt u het scherm aan om terug te keren naar het originele scherm.
- 7 -toets
- Om de spraakherkenning te activeren, zoals Siri wanneer een iPhone via Bluetooth of USB is aangesloten op het apparaat.
- 8 RESET-toets

